

GOLDEN ODYSSEY II



ELEGANT EXPLORATION



GOLDEN ODYSSEY II



ELEGANT EXPLORATION

Golden Odyssey II 80.2m (263ft) is an explorer-style yacht with spacious comfort in mind. With opulent bespoke interiors, she is the pinnacle of style and performance. Built in 1990 by the world-renowned German shipyard, Blohm+Voss, Golden Odyssey II offers outstanding opportunities for ocean cruising in unprecedented luxury.



With a cruising speed of 16 knots, a maximum speed of 18 knots and a range of 9,100 NM she is the perfect combination of luxury and performance.



This luxury vessel's sophisticated exterior design and engineering are the work of Platou Architects. The yacht's interior has been designed by Alberto Pinto.

SUN DECK

Spectacular views and a superior space for entertaining. The huge mosaic outdoor swimming pool can be transformed into a dance floor.







Sun Lounge on the Sun Deck





MAIN LOUNGE

Golden Odyssey II's interior style is nautical and traditional, dark wood interiors and marble bathrooms suggest understated elegance.



TOP DECK

The top deck is a comfortable area for lounging, featuring a jacuzzi with sun pads, a gas BBQ with hotplate and a shower. Access to the owner's observation lounge is through the glass doors.



Owner's Observation Lounge on the Top Deck



MAIN DECK

Golden Odyssey II offers elegant air-conditioned accommodation for up to 14 guests in seven suites comprising of two double staterooms, one double cabin and four twin cabins, all with en suite bathrooms.





The main deck features a spectacular aquarium. A glass partition in the main dining room provides a view through the live coral reef to the swimming pool above.

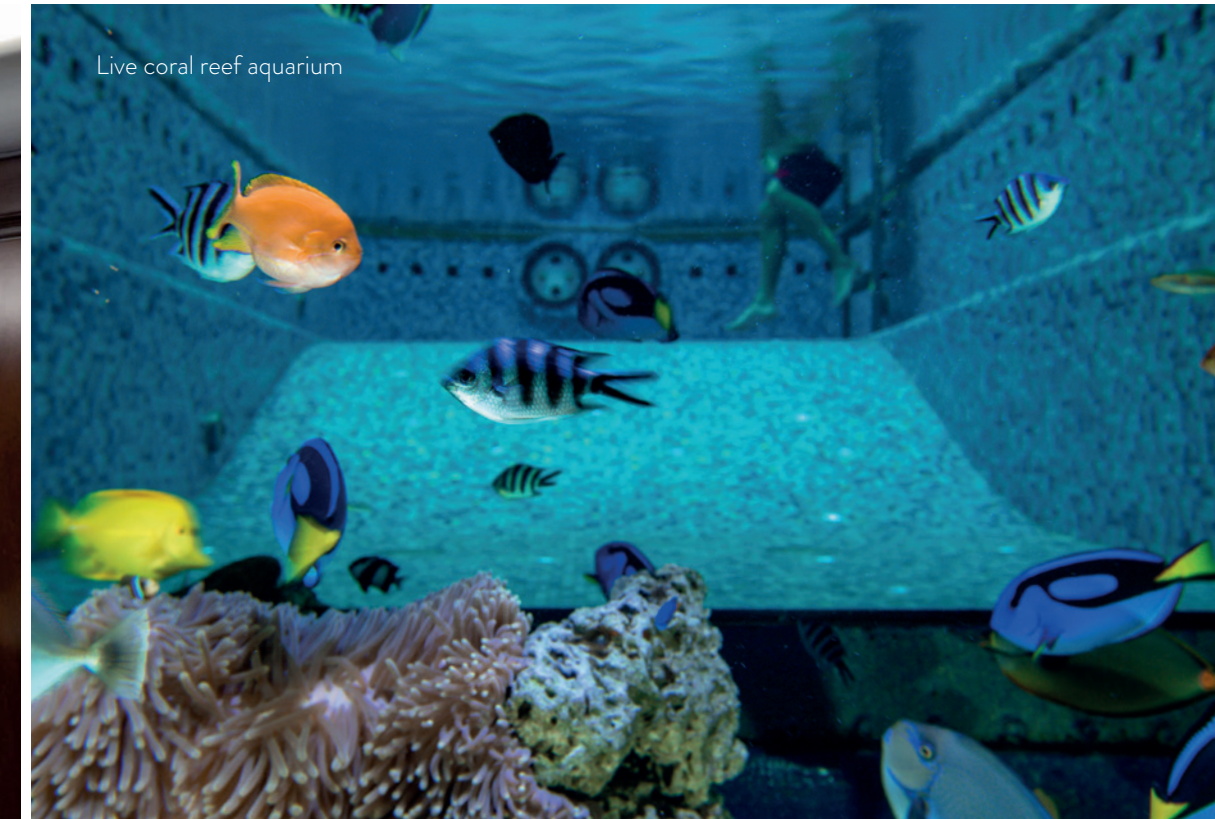

Live coral reef aquarium



Elegant dining on the Main Deck



OWNER'S SUITE

The handsome carved wooden bed sets the luxurious tone for this master stateroom. Richly polished mahogany furniture is in elegant contrast with the pale colours of the painted wood ceiling, silk carpeting and panelled walls.



Owner's Dressing Room

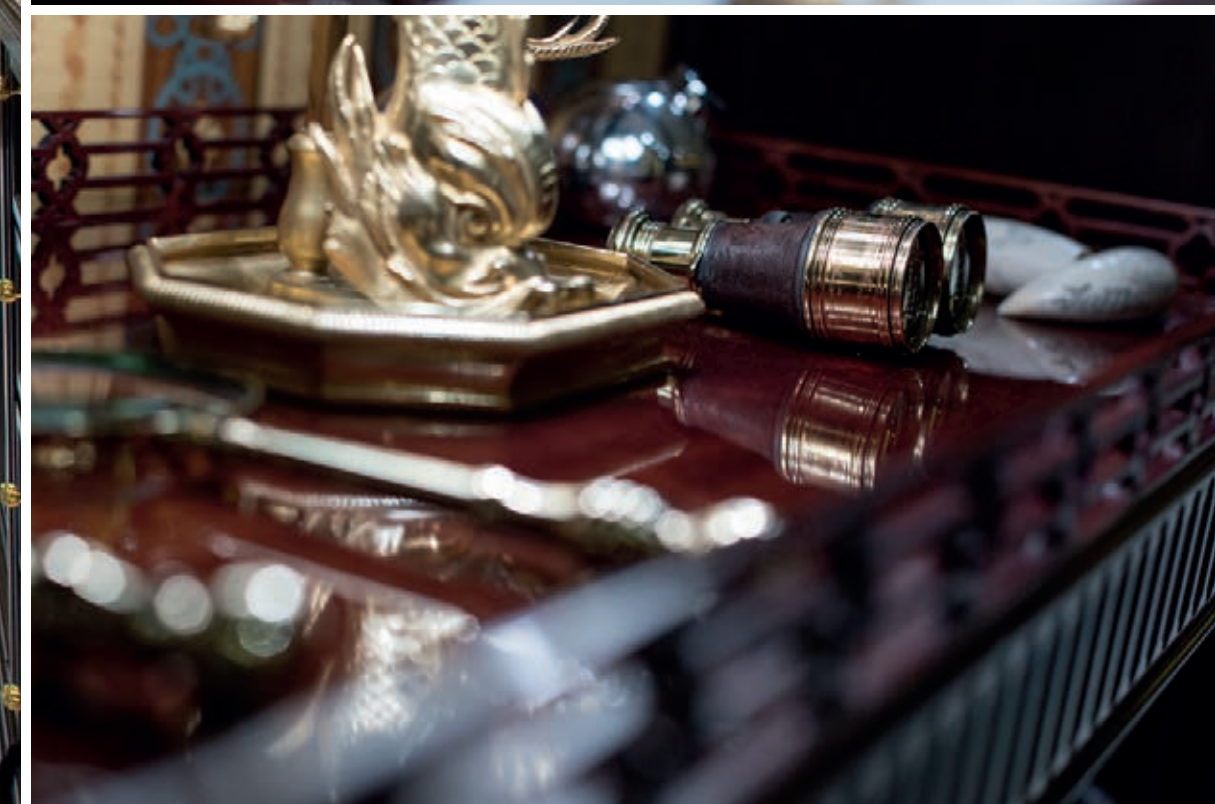

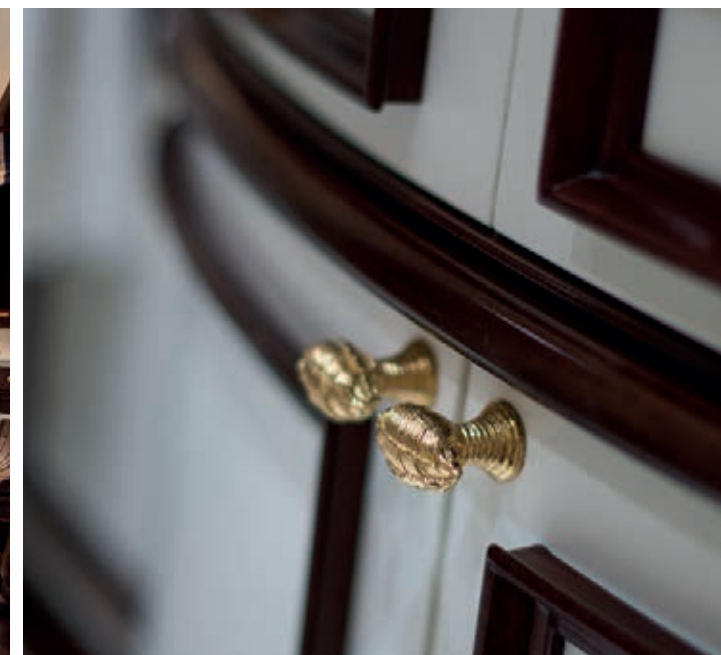



MADAME'S SUITE

Comfort and luxury is combined with spacious elegance in this delightful suite. The bedroom, with comfortable seating area is both tasteful and restful. There is a separate dressing room and magnificent bathroom, ornately decorated with glass and seashells.





GUEST SUITES

Carefully designed to make maximum use of space, one double and four twin guest cabins are comfortably furnished and feature en suite bathrooms as well as decent desk and storage space.



FITNESS & WATERSPORTS

The large well equipped gym is situated on the top deck. With a choice of four tenders and two waverunners there is plenty of opportunity to enjoy your time on the water.



DECK PLANS



TOP DECK



SUN DECK

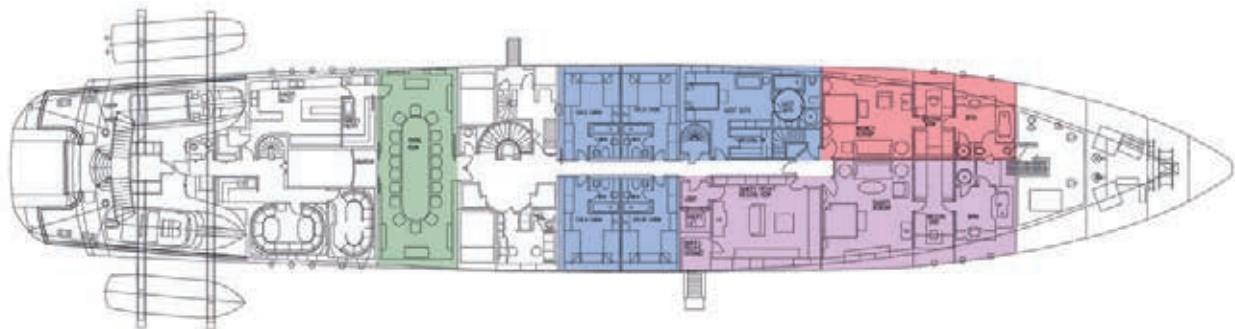

MAIN DECK

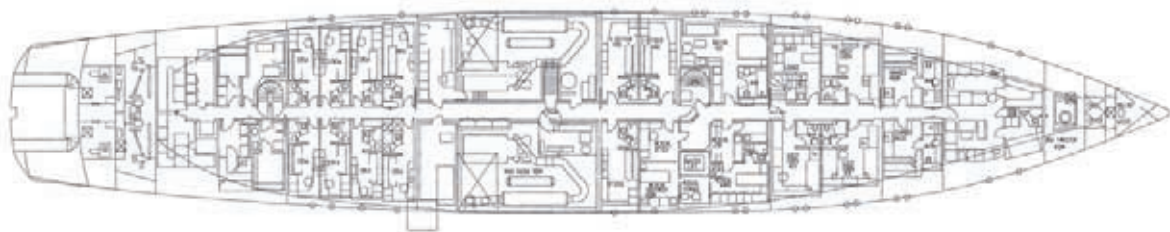

LOWER DECK

- Living Areas
- Guest Suites
- Owner's Suite
- Jacuzzi / Pool
- Madame's Suite
- Gymnasium / Sauna

SPECIFICATIONS

- TYPE

Twin Screw Diesel Displacement Yacht
- FLAG

Bermuda
- DIMENSIONS

Length Overall 80.2 m (263 ft)
Beam 12.8 m (42 ft)
Draft 4.1 m (13.3 ft)
- TONNAGE

Gross 1,864 / Net 559
- YEAR BUILT

1990
- BUILDER

Blohm+Voss, Germany
- NAVAL ARCHITECTURE

Blohm+Voss, Germany
- EXTERIOR DESIGN

Blohm+Voss/Platou Architects
- INTERIOR DESIGN

Alberto Pinto, Paris, France
- CONSTRUCTION

Hull – Steel, Superstructure – Aluminium, Deck – Teak
- CLASSIFICATION

Lloyds+100A1+LMC UMS
- MAIN ENGINES

2 × 2,868 hp Deutz
- SPEEDS

Cruising speed 16 knots
Maximum speed 18 knots
- RANGE

9,100 NM at 12 knots
- GENERATORS

2 × 600 kW (750 kVA) Deutz 8 cylinder turbocharged diesel
1 × 280 kW (350 kVA) Deutz 12 cylinder turbocharged diesel
1 × 156 kW 6 cylinder turbocharged diesel (emergency generator)
- STABILISERS

Blohm+Voss simplex – compact retractable fin
- COMMUNICATIONS

SATCOM MTN VSAT Ku-Band antenna
2 × NERA Inmarsat B terminals type Saturn B
2 × Inmarsat Fleet F77 terminals
1 × Inmarsat Standard C Thrane & Thrane TT-3606E
- ENTERTAINMENT

SKY /Direct TV. Kaleidescape Movie Server System, Multi-room Audio System with access to music library. External Audio to the Sun Deck, LED HD throughout, 2 × Seatal gyro-stabilised satellite TV dishes.
- JACUZZI

1 × Six person Sundance Jacuzzi Spa (on owner's private sun deck)
- ACCOMMODATION

OWNER:
2 × Double staterooms each with dressing room and en suite bathroom
1 × Private lounge with private beach

GUESTS:
1 × Double cabin with bathroom en suite
4 × Twin cabins with bathrooms en suite

INTERNAL OWNERS AREA:
1 × Main Lounge
1 × Pool Lounge
1 × Jacuzzi Lounge
1 × Hairdressing Salon
1 × Sauna
1 × Steam shower
1 × Powder room at entrance
1 × Main dining room
1 × Dining Area in pool lounge
Seawater aquarium with live coral in main dining room

EXTERNAL OWNERS AREA:
Pool deck – 2 × powder rooms with toilets
Pool deck – 1 × buffet table, 3 × round dining tables
Jacuzzi deck – cooking area with BBQ and hotplate
Jacuzzi deck – 1 × shower
- STAFF

2 × Twin cabins with shower rooms en suite
2 × Single cabins with shower rooms en suite
1 × Single security staff cabin
- CREW

1 × Captain cabin
1 × Engineer cabin
2 × Twin Officer cabins
3 × Officer cabins
9 × Twin crew cabins
- TENDERS

1 × Scorpion RIB 440 hp Inboard Jet drive
2 × 5.3m Novurania MX530 DL RIBS with 2 × 50 hp O/B
1 × 3.6m Novurania RIB tender MX360TR 1 × 30 hp O/B
- EXERCISE EQUIPMENT

Large fully equipped gymnasium
- CREW

29

Golden Odyssey II is offered for sale. Not for sale to US residents while in US waters. All particulars are believed to be correct at the time of going to print but cannot be guaranteed. Photography: Jeff Brown. Brochure coordination by Burgess. Brochure design and production: Wilkins & Rock UK.



London

+44 20 7766 4300

london@burgessyachts.com

Monaco

+377 97 97 81 21

monaco@burgessyachts.com

New York

+1 212 223 0410

newyork@burgessyachts.com

Miami

+1 305 672 0150

miami@burgessyachts.com

Moscow | Palma | Los Angeles | Seattle

BURGESS

www.burgessyachts.com